

Flexible Control for Houses of Worship

Flexible Control for Houses of Worship

SKAARHOJ

Blackmagicdesign vMix

Mix camera brands, models, and types as you like for control and shading the cameras using Color Fly's motorized faders and preset banks.

#113

Resources

- [Blackmagic Design, vMix](#) - Accessories and settings to connect
- [Air Fly Pro, XC7](#) - Product details and price
- [Panasonic PTZ Device Core Parameters](#) - All the parameters we support
- [Canon XC Device Core Parameters](#) - All the parameters we support
- [NewTek TriCaster Device Core Parameters](#) - All the parameters we support
- [Product Information Document Air Fly Pro](#) - Product descriptions, product images, data sheet, FAQ and videos
- [Product Information Document XC7](#) - Product descriptions, product images, data sheet, FAQ and videos
- [Blue Pill / Reactor](#) - Getting started

We are constantly developing on our integrations and this page will continuously be updated



Trophy #113

Flexible Control for Houses of Worship

SKAARHOJ

Benefits

- ★ Quickly adapt to changing team size and skill level
- ★ Accommodate different production types
- ★ Repurpose SKAARHOJ controllers quickly
- ★ Extend controller bank over time
- ★ Works with countless switchers and cameras

What to expect

With Blue Pill and Reactor, modularity is a reality and not just a dream. SKAARHOJ controllers are weaved seamlessly together through clever configurations that can be changed in a snap.

Churches experience vastly different production types and team sizes over the course of a week and with modularity you can keep cost down and create control experience for the novice and skilled volunteer alike.

Model Support

- Switcher system examples: ATEM, vMix, TriCaster, Kairos
- Camera brands: Sony, Panasonic, Canon, NewTek, PTZ Optics, Vaddio, JVC, Marshall, AIDA

Configurations

SKAARHOJ provides various default configurations for controller combinations. Here are a few examples:

"Air Fly Pro + XC7 - ATEM"

"Air Fly Pro + XC7 - vMix"

"Inline 22 + XC7 - Generic" - For PTZ control of any supported camera profile.

Learn More



Demonstration video

Manuals, Cabling Guides, Parameter Support, Press Kit

Blue Pill and Reactor

Blue Pill is a SKAARHOJ platform that boosts the capacity and capability of SKAARHOJ UniSketch controllers. Reactor is our flagship panel management application running on Blue Pill or Blue Pill Inside (BPI) powered controllers.



Reseller / Notes

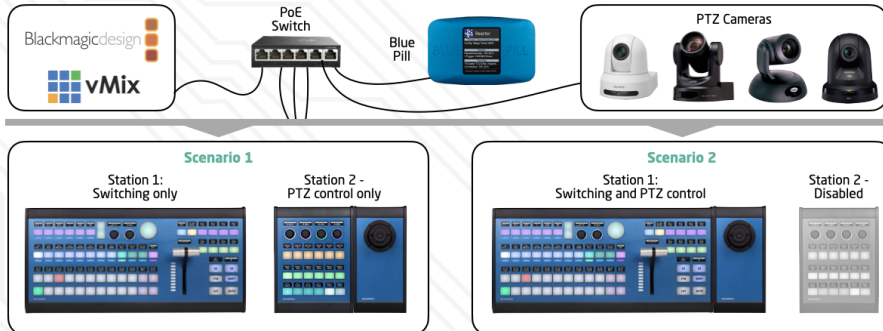
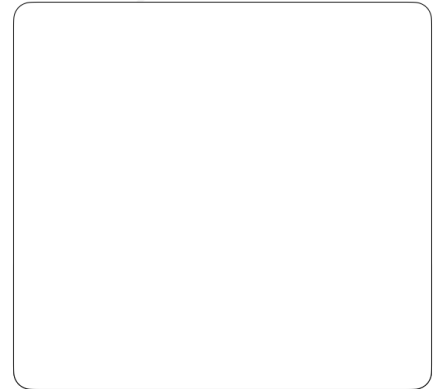

Revision #3

Created 11 April 2022 07:44:51

Updated 18 June 2026 14:31:08 by Lukas Bachschwell