

# Trophy #23: Stream Deck on a Network

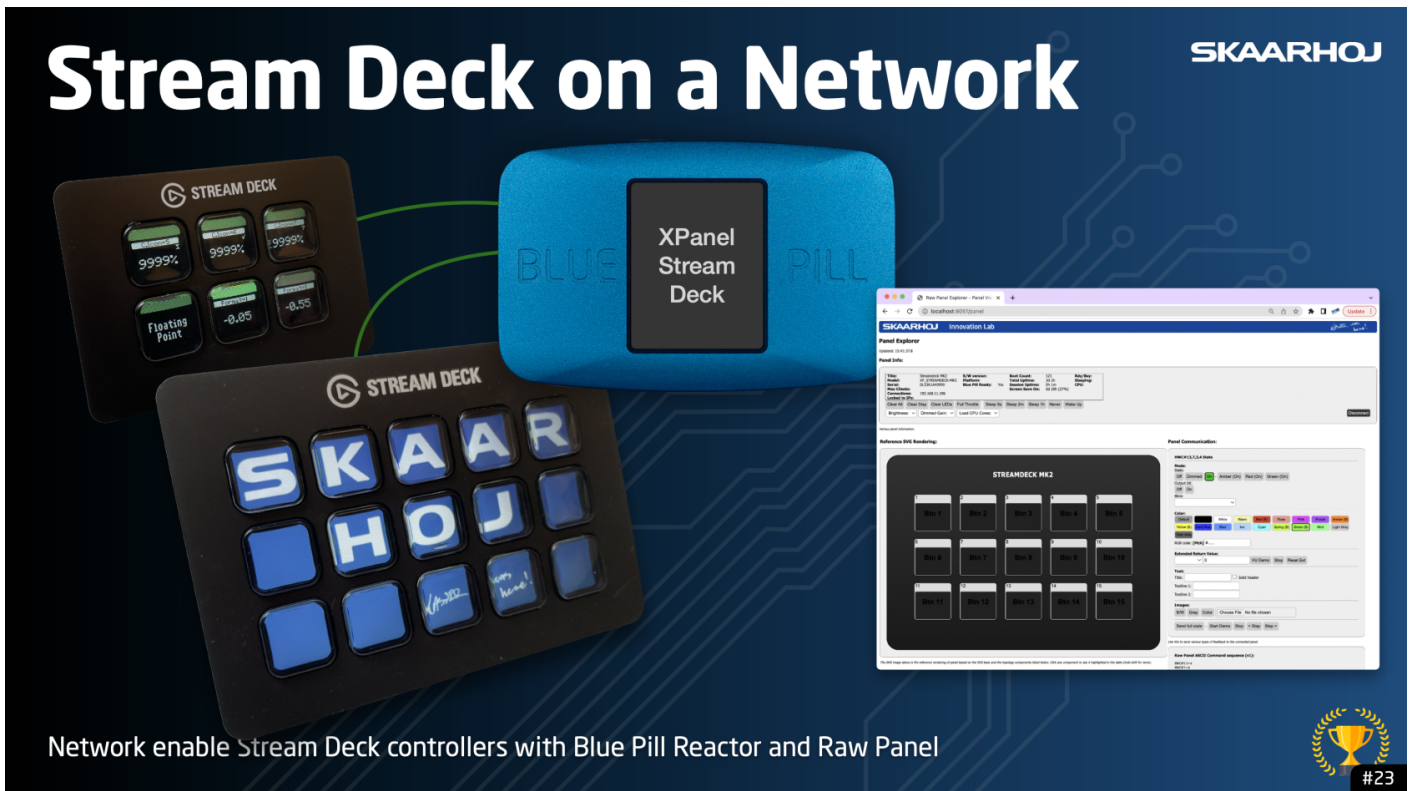

- Streamdeck with Raw Panel



### Benefits

- ★ Mix your existing Stream Deck with SKAARHOJ professional controllers
- ★ Enjoy professional configuration with Reactor
- ★ No external computer needed - connects to Blue Pill
- ★ Raw Panel enable Stream Deck over network with PoE
- ★ Add unique workflows with Stream Deck Pedal

### What to expect

With SKAARHOJ's Stream Deck application for Blue Pill you can connect one or more Stream Deck controllers to a SKAARHOJ Blue Pill product and integrate the Stream Deck seamlessly with your existing SKAARHOJ devices. In this way you can enjoy even more freedom of user friendly integration with professional SKAARHOJ panels and your existing fleet of Stream Deck devices.

The Stream Deck devices become network enabled as they are turned into Raw Panel compliant devices. This means that Reactor and any other third party application fully compliant with Raw Panel can use them.

### Application examples

- **Add a shot box** - Easily add a shot box next to your professional SKAARHOJ controller. No additional computer needed - Stream Deck connects to the SKAARHOJ device. Configure it with Reactor to control any device, with advanced navigation.
- **Foot Pedal control** - Add foot pedal control to your production
- **Raw Panel** - For integrators, you can Raw Panel enable one or more Stream Decks by connecting them to a Blue Pill Server. This means they will adhere to a common protocol you may already support (Raw Panel) and be networked.

### Licensing

The Stream Deck package comes with a trial mode for evaluation. After 10 minutes it will stop working until you restart xpanel-streamdeck. For unlimited use, you must buy a license. Please inquire for license options and check out information on the QR codes.

### Technical Note

A Stream Deck can be connected to SKAARHOJ products with USB-A ports. This is found on the larger "XC" controllers as well as the Blue Pill Server. A USB Hub with external power may be required. With a USB Hub multiple Stream Decks can be attached.

The Blue Pill package "xpanel-streamdeck" must be installed. When running, it will monitor for attached Stream Decks and when found, convert them into a Raw Panel device accessible on the network. This can be picked up by Reactor or external Raw Panel clients.

Please watch and read more from the QR code link below

### Learn More



Demonstration video

More information

### Model Support

- Stream Deck Models supported include Stream Deck (Orig + MK2), XL, Mini, Pedal and Plus

### Notes

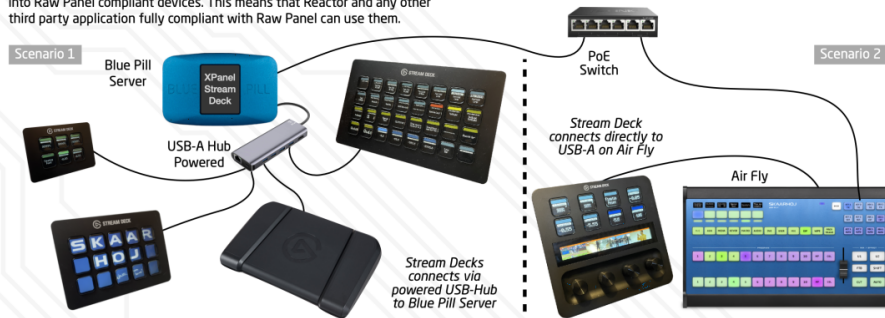

Revision #3

Created 2 December 2022 08:00:04 by Kasper

Updated 5 August 2023 09:00:57 by Kasper